



**The Miriam Hospital**  
*Lifespan. Delivering health with care.™*

Building A Replacement Project  
Summer 2024

# Building “A”



## The Need for Renovation

- Built in 1926
- Building envelope is deteriorating
- Waste and water piping is deteriorating
- Doorways and spaces need to meet ADA codes
- HVAC systems are outdated, require frequent and costly repairs, and are energy inefficient
- Windows are outdated, leak, and energy inefficient

*These are barriers to providing the best care to the community and committing to carbon neutralization.*



# Project Overview

The proposed project will:

- Redesign the Emergency Department to provide:
  - a more geographically contiguous and efficient flow
  - a dedicated area for behavioral health patients; and
  - additional space for ambulance bay.
- Improve size and privacy of patient care areas, increasing complement of private rooms.
- Relocate our inpatient oncology unit.

Project will be completed in phases so that there is minimal disruption to existing operations and care of patients.

The first phase will include removing Building A and replacing it with a new building that includes a basement, three above grade stories and a rooftop penthouse for mechanical equipment.

The redesigned ED will occupy the first floor and single patient rooms will occupy the second and third levels of the new building.





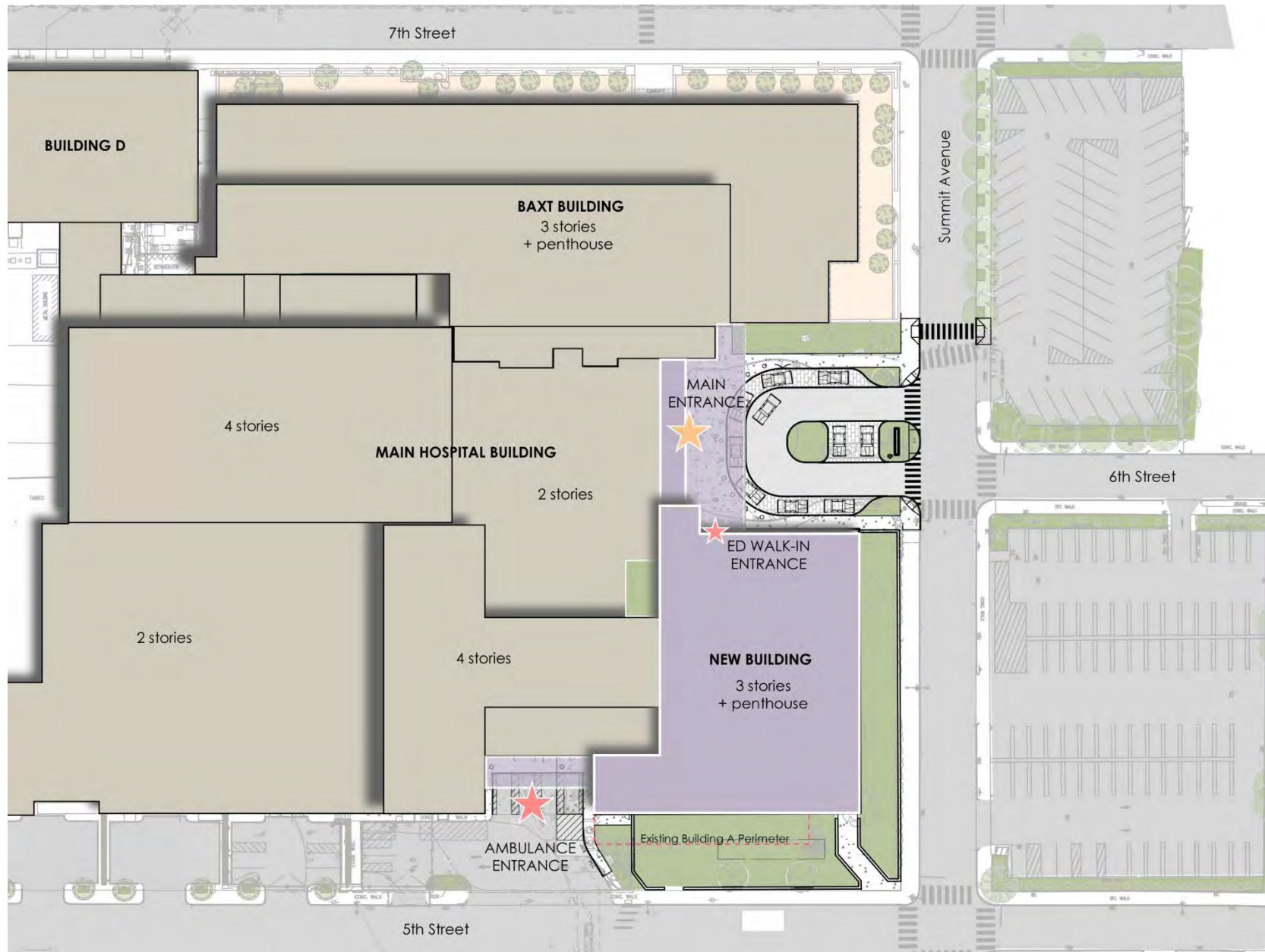

## Proposed Site

- Align with Baxt Building along Summit Ave
- Realign building face along 5<sup>th</sup> St to match existing buildings
- Match Baxt Building height
- Add site wall to match Baxt Building street edge condition
- Remove pedestrian crossing at middle of 5<sup>th</sup> St (from Fain Building) and relocate pedestrian traffic to existing street corner
- Relocate ED Walk-in Entrance from 5<sup>th</sup> St to Main Entrance loop/drop-off
- Add 1 Ambulance parking spot under canopy



# What a contemporary ED should look like and the impact on care

- Shorter Wait Times
- Increased Privacy
- Improved Coordination of Care
- Enhanced Behavioral Health Delivery
- Enhanced Imaging Suite
- Enhanced Geriatric Care
- Modern Physical Environment







Post-renovation rendering





# THE MIRIAM HOSPITAL

EMERGENCY

Emergency Department

Post-renovation rendering

# Preliminary Renovation **Schedule**

Conceptual Design.....completed April 2024

CON Submission.....June 2024

Design Development/Construction Documents.....July 2024-April 2025

Local Permitting and Review process.....completed by April 2025

Construction Duration.....May 2025-May 2027

